

# Harvey Medical Course

Second Year

Second Semester

Students' Guide

*Version 1*

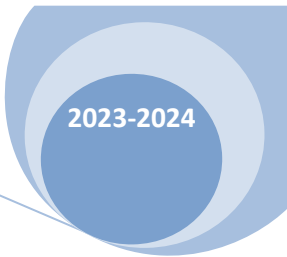

## Summary

Harvey Medical Course .....	1
Second year, Second Semester's Teachers .....	3
Courses and modules .....	4
Teachers.....	5
Office time and meeting place for students .....	6
Teaching Calendar.....	8
Calendar.....	8
Laboratories .....	8
Well-being and disability .....	9
Syllabus and course material .....	10
Exam schedule .....	10
Exam modalities .....	10
Lecture theatre .....	11
Maps and indications to reach the lecture theatre.....	11

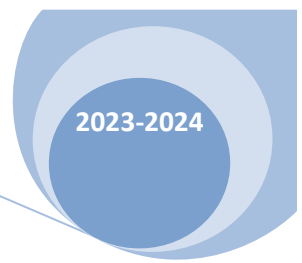

**Dear Students,**

Here we are! Time to start the second semester of the Second Year.

Again, in this brochure you will find information useful to plan your study.

Teaching and exams will take place in presence.

**It is very important that you plan your studying schedule very well in advance to stay on track. In case of problems, ask for support as soon as possible in order to anticipate possible issues.**

We all hope you will enjoy the new courses!

Yours,

**Second year, Second Semester's Teachers**

## Courses and modules

Integrated course	Modules	Teacher	CFU	Hours	Lectures
506516 - BIOLOGY OF DISEASE	501709 - GENERAL PATHOLOGY	Arianna Palladini	1	8	4
		Giorgia Zadra	1	8	4
		Carlo Gaetano	1	8	4
		Nora Bloise	1	8	4
		Giuseppe Biamonti	1	8	4
	506518 - GENERAL PATHOPHYSIOLOGY	Claudia Scotti	1	8	4
		Hugo de Jonge	1	8	4
	501708 - IMMUNOLOGY	Ilaria Ferrarotti	4	32	16
	508092 - LABORATORY OF IMMUNOLOGY A	Hugo de Jonge	1	12	1
	508093 - LABORATORY OF GENERAL PATHOLOGY A	Arianna Palladini	1	12	1
	509628 - LABORATORY OF HISTOPATHOLOGY	Arianna Palladini	1	12	1
Total			14	124	50
506708 - LABORATORY MEDICINE	501722 - CLINICAL BIOCHEMISTRY	Giovanni Palladini	4	32	16
		Mario Nuvolone	1	8	4
	508094 - LABORATORY OF CLINICAL GENETICS	Edoardo Errichiello	1	12	4
Total			6	52	24
501710 - MICROBIOLOGY	506517 - BACTERIOLOGY AND PARASITOLOGY	Piazza Aurora	3	24	12
		Enrico Brunetti	1	8	4
	504495 - VIROLOGY A	Fausto Baldanti	1	8	4
	504496 - VIROLOGY B	Daniele Lilleri	1	8	4
	506513 - CLINICAL MICROBIOLOGY A	Fausto Baldanti	1	8	4
	506514 - CLINICAL MICROBIOLOGY B	Fausto Baldanti	1	8	4
Total			8	64	32
<b>Total CFUs</b>			<b>28</b>	<b>240</b>	<b>100</b>

## Teachers

Teacher	Role	Telephone	E-mail	Website
Fausto Baldanti	PA	0382.502420	fausto.baldanti@unipv.it	<a href="http://diplinchir.unipv.eu/site/home/personedocenti-e-ricercatori/sezione-diagnostica-e-clinica-integrata/scheda900005301.html">http://diplinchir.unipv.eu/site/home/personedocenti-e-ricercatori/sezione-diagnostica-e-clinica-integrata/scheda900005301.html</a>
Enrico Brunetti	RU	0382.502799	enrico.brunetti@unipv.it	<a href="http://diplinchir.unipv.eu/site/home/personedocenti-e-ricercatori/sezione-diagnostica-e-clinica-integrata/scheda900004774.html">http://diplinchir.unipv.eu/site/home/personedocenti-e-ricercatori/sezione-diagnostica-e-clinica-integrata/scheda900004774.html</a>
Daniele Lilleri	BG	0382.502420	d.lilleri@smatteo.pv.it	<a href="https://orcid.org/0000-0001-7747-7622">https://orcid.org/0000-0001-7747-7622</a> <a href="https://www.sanmatteo.org/site/home/attivita-assistenziale/scheda9268.html">https://www.sanmatteo.org/site/home/attivita-assistenziale/scheda9268.html</a>
Hugo de Jonge	RTDB	0382.986946	hugo.dejonge@unipv.it	N.A.
Mario Nuvolone	RTDA	0382.502994	mario.nuovolone@unipv.it	<a href="http://amiloidosi.it/index.php/it/">http://amiloidosi.it/index.php/it/</a>
Giovanni Palladini	PA	0382.502994	giovanni.palladini@unipv.it	<a href="http://medmol.unipv.eu/site/home/personedocenti---ricercatori/scheda870002443.html">http://medmol.unipv.eu/site/home/personedocenti---ricercatori/scheda870002443.html</a>
Claudia Scotti*	RU	0382.986335	claudia.scotti@unipv.it	<a href="http://medmol.unipv.eu/site/home/personedocenti---ricercatori/scheda870004698.html">http://medmol.unipv.eu/site/home/personedocenti---ricercatori/scheda870004698.html</a>
Ilaria Ferrarotti	RTDB	0382.502620	ilaria.ferrarotti@unipv.it	<a href="https://unipv.unifind.cineca.it/get/person/015881">https://unipv.unifind.cineca.it/get/person/015881</a>
Aurora Piazza	RTDA	0382.984133	aurora.piazza@unipv.it	<a href="https://unipv.unifind.cineca.it/individual?uri=http%3A%2F%2Firis.unipv.it%2Fresource%2Fperson%2F681787">https://unipv.unifind.cineca.it/individual?uri=http%3A%2F%2Firis.unipv.it%2Fresource%2Fperson%2F681787</a>
Arianna Palladini	RTDB	0382.986331	arianna.palladini@unipv.it	<a href="https://medicinamolecolare.dip.unipv.it/it/ricerca/linee-e-gruppi-di-ricerca/immunologia-e-patologia-generale/immunologia-dei-tumori-e-vaccini">https://medicinamolecolare.dip.unipv.it/it/ricerca/linee-e-gruppi-di-ricerca/immunologia-e-patologia-generale/immunologia-dei-tumori-e-vaccini</a>
Giorgia Zadra	PR	0382.546332	giorgia.zadra@igm.cnr.it	<a href="https://www.igm.cnr.it/en/">https://www.igm.cnr.it/en/</a>
Carlo Gaetano	PR	349 4663134	carlo.gaetano@maugeri.it	<a href="https://www.icsmaugeri.it/professionisti/carlo-gaetano?p=curriculum-vitae">https://www.icsmaugeri.it/professionisti/carlo-gaetano?p=curriculum-vitae</a>
Nora Bloise	AdR	0382.987725	nora.bloise@unipv.it	<a href="http://molecularmedicine.unipv.it/research-groups/biochemistry/l-visai/">http://molecularmedicine.unipv.it/research-groups/biochemistry/l-visai/</a>
Giuseppe Biamonti	PR	0382 546334	giuseppe.biamonti@igm.cnr.it	<a href="https://www.igm.cnr.it/istituto-2/organizzazione/personale/">https://www.igm.cnr.it/istituto-2/organizzazione/personale/</a>
Edoardo Errichiello	RD	0382.987731	edoardo.errichiello@unipv.it	<a href="http://www.telethon.it/ricerca-progetti/ricercatori/dettaglio-ricercatore/enza-maria-valente">http://www.telethon.it/ricerca-progetti/ricercatori/dettaglio-ricercatore/enza-maria-valente</a>

\* Second semester coordinator. Legend: CB and PR: Docente a contratto; PO: Professore ordinario; PA: Professore Associato; RD: Ricercatore a tempo determinato RC: Ricercatore confermato; ND: Personale tecnico; AdR: Assegnista di Ricerca.

## Office time and meeting place for students

<i>Teacher</i>	<i>Office hours for students</i>	<i>Address and room</i>
Fausto Baldanti	Please, make an appointment in advance by email.	Microbiology and Virology Unit IRCCS Policlinico San Matteo Foundation Viale Golgi 19 Padiglione 30, Underground floor
Enrico Brunetti	Please, make an appointment in advance by email.	Department of clinico-surgical, diagnostic and pediatric sciences Unit of Infectious and Tropical and Hepatology IRCCS Policlinico San Matteo Foundation
Mario Nuvolone	Please, make an appointment in advance by email.	Laboratory of Biochemistry, Biotechnology and Advanced Diagnostics, Forlanini Bldg, IRCCS Policlinico San Matteo Foundation Viale Golgi 19 III Floor
Giovanni Palladini	Please, make an appointment in advance by email.	Clinical Biochemistry, Centro per lo Studio e la Cura delle Amiloidosi Sistemiche Padiglione Forlanini Fondazione IRCCS Policlinico San Matteo Viale Golgi, 19
Arianna Palladini	Please, make an appointment in advance by email.	Department of Molecular Medicine Unit of Immunology and General Pathology, Via Ferrata, 9 (First floor)
Claudia Scotti	Please, make an appointment in advance by email.	Department of Molecular Medicine Unit of Immunology and General Pathology, Via Ferrata, 9 (First floor)
Giorgia Zadra	Please, make an appointment in advance by email.	IGM-CNR, Via Abbiategrosso, 207 27100 Pavia (Entrata da Via Ferrata 9A, chiedere centralino)
Carlo Gaetano	Please, make an appointment in advance by email.	Laboratory of Epigenetics Istituti Clinici Scientifici Maugeri Via Maugeri 4, 27100 Pavia
Nora Bloise	Please, make an appointment in advance by email.	Department of Molecular Medicine, Unit of Biochemistry, viale Taramelli 3/b
Giovanni Maga	Please, make an appointment in advance by email.	Istituto di Genetica Molecolare “Luigi Luca Cavalli-Sforza” Via Abbiategrosso, 207 – 27100 PAVIA
Giuseppe Biamonti	Please, make an appointment in advance by email.	Istituto di Genetica Molecolare “Luigi Luca Cavalli-Sforza” Via Abbiategrosso, 207 – 27100 PAVIA
Edoardo Errichiello	Please, make an appointment in advance by email.	Department of Molecular Medicine Unit of Human Genetics, Via Forlanini, 14 Ground floor

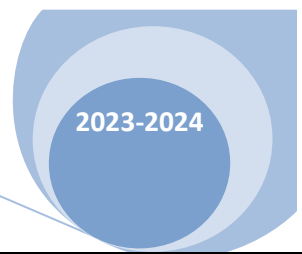

Daniele Lilleri	Please, make an appointment in advance by email.	Microbiology and Virology Unit IRCCS Policlinico San Matteo Foundation Viale Golgi 19 Padiglione 30, Underground floor
Ilaria Ferrarotti	Please, make an appointment in advance by email.	Department of Internal Medicine and Therapeutics - Section of Pulmonology IRCCS Policlinico San Matteo Foundation
Aurora Piazza	Please, make an appointment in advance by email.	Microbiology and Clinical Microbiology Unit Viale Brambilla 74 First floor, First door on the left (label on the door)

## Teaching Calendar

**Courses starting date:**

**4<sup>th</sup> March 2024**

### Calendar

The U-planner teaching calendar for your course is available at this link:

<https://unipv.prod.up.cineca.it/calendarioPubblico/linkCalendarioId=6131de259f5a940011ad7e93>

**Please, keep it constantly under control to be updated about possible changes in due course.**

### Holidays

Easter Holidays: 28<sup>th</sup> March-2<sup>nd</sup> April 2024

Bank holiday: 25<sup>th</sup>-26<sup>th</sup> April

Bank holiday: 1<sup>st</sup> May.

### Laboratories

**Laboratories** and **tutorials** will be organized in the afternoon for several modules:

**Laboratory of Clinical Genetics**

**Laboratory of Immunology**

**Laboratory of General Pathology**

**Laboratory of Histopathology**

Students will be split into groups, that will be communicated during the courses along with locations.



## IMPORTANT: Attendance

Please, note that the Harvey course has **MANDATORY** attendance.

For the **Biology of Disease** course, you are required to attend the following percentage of lectures:

75% for Immunology

75% for Pathology, which would include General Pathology, General Pathophysiology and the Histopathology Lab.

75% for Laboratory of Immunology

75% for Laboratory of General Pathology.

If you fail the minimums, you will not be able to take the exam in the first June session.

Please, also note that the content of the laboratories will be assessed within the final exam.

For **Laboratory Medicine** and **Microbiology**, rules will be communicated at the beginning of the course.

Attendance will be checked by the teachers using the “MyUniPV” App, available for free on Google Play and Apple Store. Please, download and install it on your mobile phone in case you have not yet done so. Access requires your credentials. Alternatively, you can access the check-in procedure at the following link:

<https://unipv.appmobile.cineca.it/>

In case of health or other types of issues that you expect will prevent you from attending classes, you are invited to immediately contact the teachers and/or the second-year coordinator to clarify the situation. Please, note that you will be required to prepare and provide documents demonstrating your current issue (for example, illness) in order to justify your absence to the teachers and to the Dean of the course. They will then suggest you the best course of action.

## Well-being and disability

At Harvey, we very much care about your well-being: we want your studying experience to be challenging, but enriching both from the scientific and the human point of view. In case you experience stress or other problems which challenge your physical and mental well-being, please contact the second-year coordinator (claudia.scotti@unipv.it), C.O.R. or Prof. Gabriele Ceccarelli (gabriele.ceccarelli@unipv.it) to ask for suggestions. A psychological support is also available from C.O.R. Ways to access it are available here:

<https://medicineandsurgeryharvey.cdl.unipv.it/en/services/counselling-and-healthcare>

If you have a disability, this link is for you:

<https://saisd.unipv.it/index.php/en/>

## Syllabus and course material

In [Syllabus](#) you will find the details of each course you are going to attend.

### Links to Syllabus

[Biology of disease](#)

[Microbiology](#)

[Laboratory Medicine](#)

The teaching material is located on the [Kiro](#) Platform and each teacher will arrange any other forms of extra material that will need to be provided to you.

### Links to course material

[Kiro platform](#)

## Exams

### Exam schedule

Exam dates along with locations are published in ESSE3.

### Exam modalities

Exams will be in various format: oral interview, written examinations on paper or, alternatively, at the computer through the Kirotesting platform, the twin of Kiro, in which case they will typically be held in a computer room.

Please, inform the teachers as soon as possible in case you have specific requirements (e.g. disabilities), which require special organization of the exam sessions.

## Lecture theatre

### Aula G.R. Burgio

IRCCS Policlinico San Matteo

Clinics of Pediatrics

Building n. 31

First Floor

### Maps and indications to reach the lecture theatre

The “Aula Burgio” Lecture theatre is located inside Policlinico San Matteo. The main entrance to the hospital is located in Piazzale Golgi, 2, but you can also access it from Via Campeggi (“Ingresso DEA”) and, soon, through an entrance dedicated to the students. Here are a satellite view and a map to help you orientate yourself:

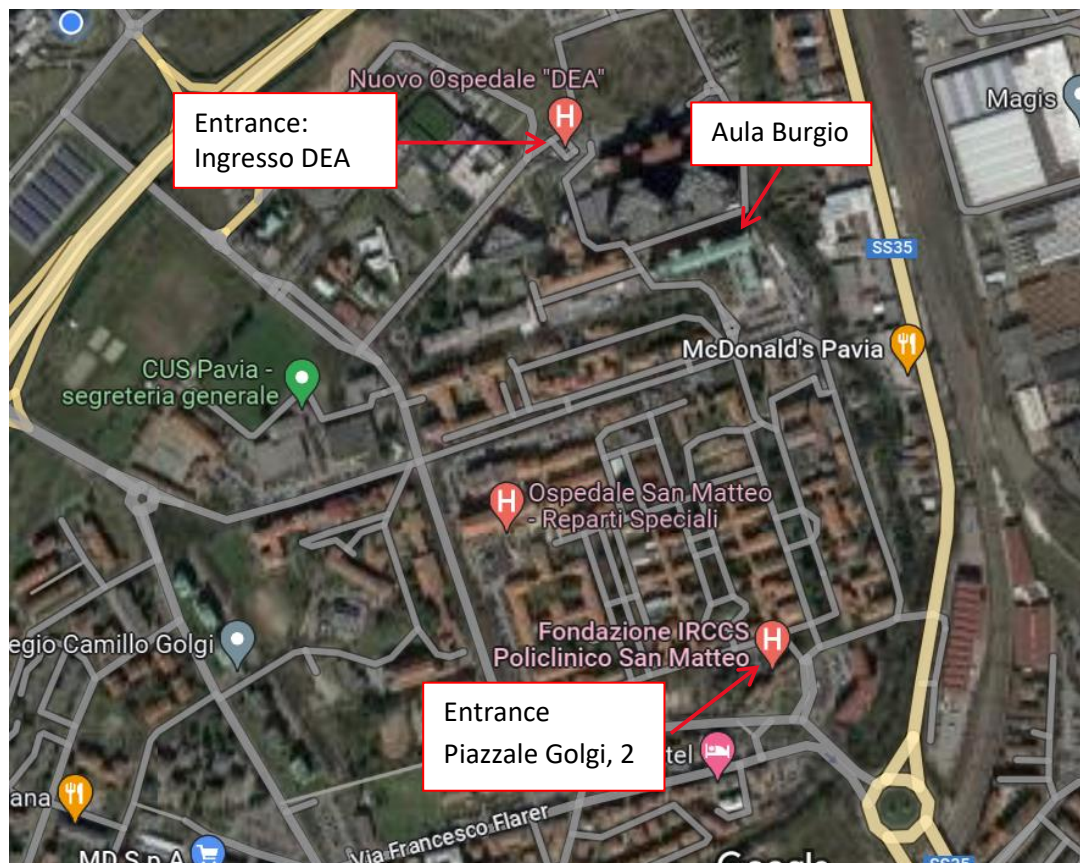

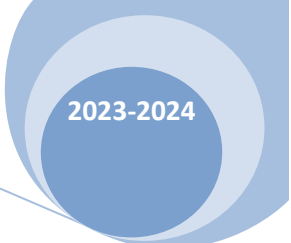

Below, in blue and fuchsia the routes you can take ON FOOT to reach Building 31 (Pediatrics) starting from the entrances in Via Campeggi and in Piazzale Golgi, respectively.

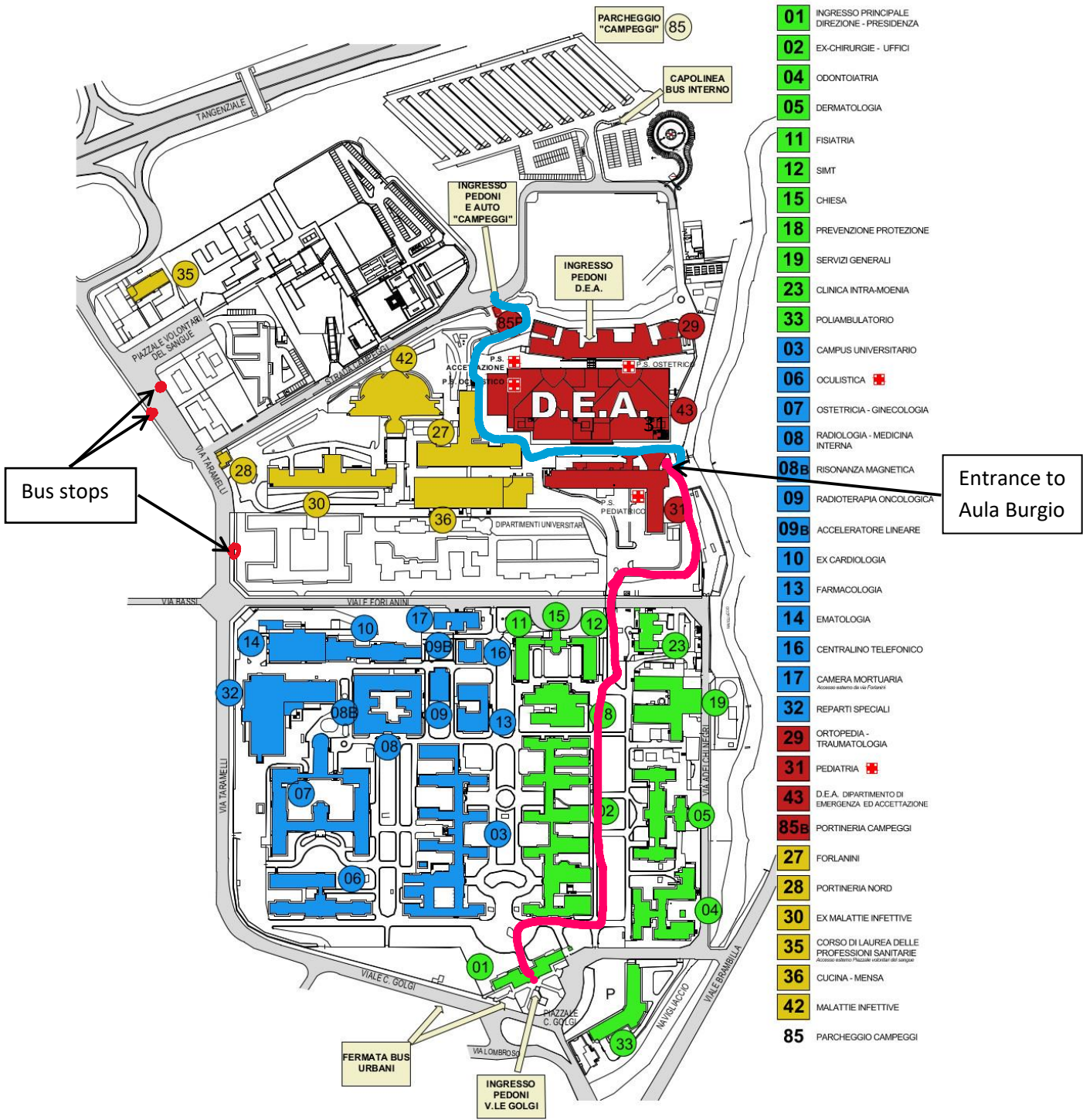



If you have a car, you must park it outside unless you have a disability. If you need to apply for a disability permit, please, contact the Disability Office of the University in order to have indications on how to proceed. The parking lot “Parcheggio Campeggi”, n. 85 on the map, is a fee-based service.

The “Aula Burgio” lecture theater is located at the first floor of the Pediatrics Clinics building. Here are some pictures to help you find it in case you arrive from the entrance in Via Campeggi. Below, on the left, a picture of the outside of the Clinics, Building n. 31. The curved part corresponds to Aula Burgio. Following this curved part, you will find the small block in the red circle, which contains the entrance to the stairs which lead to Aula Burgio.

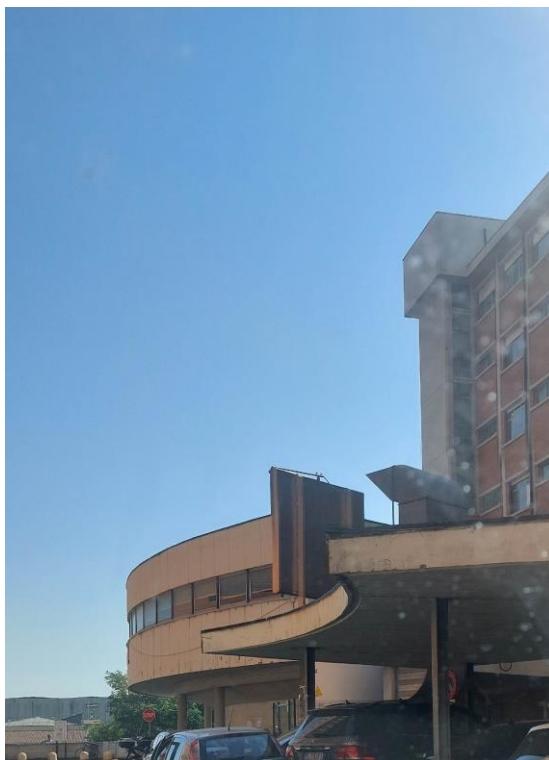

On the outside of the block, on your right, you will find the indication to Aula Burgio (red circle, picture on the left, below), and, in front of you, the entrance door (picture on the right, below). After the door, you will find the stairs on your right.



The stairs are on your right, behind the wall. Go to the first floor and enter the door you find on your right. Turn right again and you will find the entrance door to Aula Burgio.



Welcome to the inside of Aula Burgio!



## Prof. Burgio

Prof. Burgio was an important paediatrician. Here you can find his short biography in English, introduced by a paragraph in Italian:

<https://ordinemedicipa.it/notizia.php?tid=1716>





### Laboratory LE1 and LE2

Department of Molecular Medicine  
Via Torquato Taramelli, 3B

You will have access to the new Teaching laboratories, which have required an investment of more than 600.000 euros, still growing, and include the most advanced and sophisticated instrumentation for cell and molecular biology:

<https://medicinamolecolare.dip.unipv.it/it/didattica/laboratori-didattici>

The laboratories are located in the Biochemistry building:





The door leading to the LE2 Laboratory is the one at the top of the stairs (read arrow in the figure below). On the same floor you will find toilettes.

